



# EIGER

HYGIENE

## SANITIZATION SERIES

### AUTOMATIC COUNTER-TOP SANITIZER DISPENSER



## ***INSTRUCTION MANUAL***

*Please read these instructions carefully and retain for future reference.*



EG-SDC02

## PACKAGE CONTENTS

- Battery Operated Eiger Hygiene Countertop Sanitizer Dispenser (Batteries not included)
- Instruction Manual

## HIGHLIGHTS

- No-touch Automatic Sensor
- Refillable 280ml Cartridge
- Suitable for Gel Sanitizer

## SPECIFICATIONS

- |                |                                |
|----------------|--------------------------------|
| • Outer Size:  | L72 x W145 x H223 mm           |
| • Capacity:    | 280 ml                         |
| • Drop Volume: | 0.8-1 ml                       |
| • Weight:      | 243 g                          |
| • Material:    | ABS + PC                       |
| • Batteries:   | 4 x 1.5 V "AAA" (Not Included) |

## IDENTIFYING PARTS

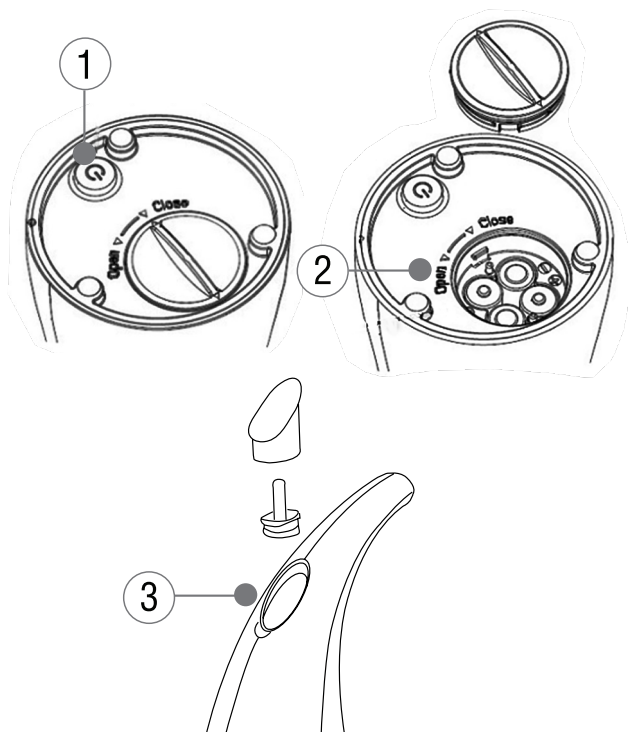

1. On / Off Button
2. Battery Compartment
3. Sanitizer Cartridge

## TROUBLESHOOTING

If There Is No Power:

1. Check that batteries are installed correctly.
2. Check that the power is switched on.

If The Dispenser Doesn`T Work:

1. Make sure the air has been worked out of the pump on first use.
2. Ensure there is sanitizer liquid in the cartridge.

## CLEANING & CARE INSTRUCTIONS - GENERAL

- **Before Cleaning:** Ensure that your dispenser is turned off before cleaning or maintaining it.
- **Cleaning:** Wipe down the surface of your Dispenser using a soft cloth.
- Do not use any harsh or abrasive cleaning chemicals or materials on your Dispenser as doing so may damage or scratch the surface finish.

## SAFETY PRECAUTIONS

1. Do not operate the sanitizer dispenser when the sanitizer cartridge is empty as this will damage the pump. Always inspect the level before use.
2. A flashing light means low battery. Please replace batteries to ensure the product operates correctly.
3. Please do not shake the product.
4. If the product is not in use for an extended period of time, please remove the batteries.
5. Ensure that the sanitizer cartridge cover is properly closed to prevent leakage.
6. This product is designed for domestic use only. Any commercial use may result in the warranty being invalidated.
7. Do not immerse the product in water or other liquid.
8. Do not place the product in direct sunlight to avoid damage.
9. Normal working temperature is 3°C ~ 40°C

## ENVIRONMENTALLY FRIENDLY DISPOSAL

### IMPORTANT INFORMATION FOR CORRECT DISPOSAL OF THE PRODUCT IN ACCORDANCE WITH THE EUROPEAN DIRECTIVE ON WASTE ELECTRICAL AND ELECTRONIC EQUIPMENT.

At the end of its working life, the product must not be disposed of as urban waste. It must be taken to a special local authority differentiated waste collection center or to a dealer providing this service. Disposing of a household appliance separately avoids possible negative consequences for the environment and health deriving from inappropriate disposal and enables the constituent materials to be recovered to obtain significant savings in energy and resources. As a reminder of the need to dispose of household appliances separately, the product is marked with a crossed-out wheeled dustbin.



## DISCLAIMER

All product and company names are trademarks™ or registered® trademarks of their respective holders. Use of them does not imply any affiliation with or endorsement by them.

## WARRANTY

This Eiger Hygiene Sanitizer Dispenser comes with a standard 12-month limited warranty against manufacturing defects and faults.

Should the product be unboxed with any faulty parts, poor finishing or visible damage, or fail to perform due to a manufacturing defect or poor workmanship, please return it with your proof of purchase (till slip or invoice) to the store of purchase for an exchange, or repair, depending on the store's returns policy.

This warranty commences from the date of purchase.  
Kindly retain your proof of purchase as well as the packaging for your warranty period.

### **NOTE:**

The warranty does not apply to a product that:

- a) Has failed due to excessive wear and tear beyond what is considered to be reasonable.
- b) Has been misused or neglected.
- c) Has been damaged accidentally or by Force Majeure including fire and flooding.
- d) Has been used or operated contrary to operating or maintenance instructions outlined in this manual.

The Store of Purchase / Seller cannot accept any returned products that have not been returned in accordance with this warranty or which does not follow their own Returns Policy. Please refer to the Store of Purchase / Sellers Returns Policy for details.

Should you require any further assistance or have any questions on your warranty, please contact the store of purchase.